

SPARE PARTS LIST

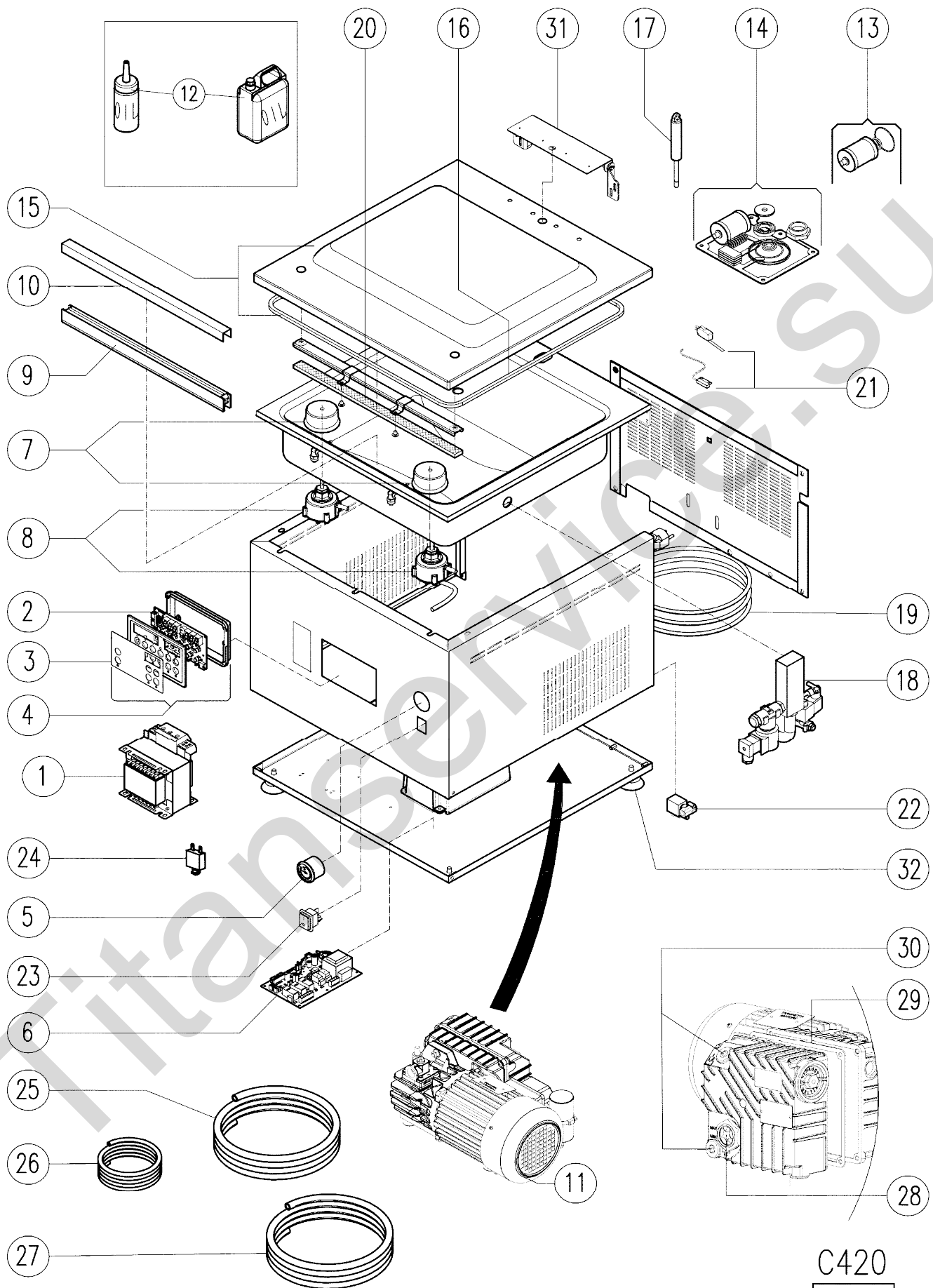

C420
1960

SPARE PARTS LIST

| SPARE PARTS LIST C420 (AVM420) | | | | | |
|--------------------------------|-----------|---|---------------------|-------------------|-----------|
| No. Part | Code Part | Description | Validity start date | Validity end date | Notes |
| 1 | 1601931 | TRANSFORMER 200VA 110/10-12V | 01/01/1900 | 31/12/2099 | 110V 1B |
| 1 | 1604098 | TRANSFORMER 200VA 230/10-12-16V | 01/01/1900 | 31/12/2099 | 230V 1B |
| 1 | 1604109 | TRANSFORMER 200VA 100-110/10-12-16 | 01/01/1900 | 31/12/2099 | 100V 1B |
| 1 | 1603281 | TRANSFORMER 400VA 220/12-18V | 01/01/1900 | 31/12/2099 | 230V 2B |
| 1 | 1601129 | TRANSFORMER 400VA 100-110/12-18V | 01/01/1900 | 31/12/2099 | 100V 2B |
| 2 | 1604123 | COMMAND BOARD N059.0 | 01/01/1900 | 31/12/2099 | |
| 3 | 1604124 | CONTROLS STICKER C-SERIES | 01/01/1900 | 31/12/2099 | |
| 4 | 1604125 | COMPLETE CONTROL PANEL N089 C-SERIES | 02/01/1900 | 31/12/2099 | |
| 5 | 1604105 | VACUUM GAUGE D=40 | 01/01/1900 | 31/12/2099 | |
| 6 | 1604447 | POWER BOARD L084 100V C-SERIES | 01/01/1900 | 31/12/2099 | 100V |
| 6 | 1604449 | POWER BOARD L084 230V C-SERIES | 01/01/1900 | 31/12/2099 | 230V |
| 6 | 1602473 | POWER BOARD L084 110V C-SERIES | 01/01/1900 | 31/12/2099 | 110V |
| 7 | 1604056 | PROTECTIVE CAP (2 PCS) EVOX/C-SERIES/SPACE/IDEA | 01/01/1900 | 31/12/2099 | |
| 8 | 1604128 | ASSEMBLY PISTON (2 PCS) C412/C420 (NO HYDROF.) | 01/01/1900 | 08/10/2014 | |
| 8 | 1604127 | ASSEMBLY PISTON C308/C310/C312/C412/C420 (2 PC/PCS) | 09/10/2014 | 31/12/2099 | |
| 9 | 1604131 | SEALING BAR 421X30X20 C412/420-IDEA40/41/42 | 01/01/1900 | 31/12/2099 | |
| 10 | 1604427 | HAVANA TEFLON BAND L=65MM (1 MT) IDEA/ MC/NEW/V.2010/400G-DG/VM98/F420/C-SERIES | 01/01/1900 | 31/12/2099 | |
| 11 | 1602750 | VACUUM PUMP LC20 220-240V 50/60HZ | 01/01/1900 | 31/12/2099 | 230V |
| 11 | 1604135 | VACUUM PUMP LC 20 100-115V 50/60HZ | 01/01/1900 | 31/12/2099 | 110V |
| 11 | 1602901 | VACUUM PUMP LC 20 100V 50/60HZ | 01/01/1900 | 31/12/2099 | 100V |
| 12 | 1601423 | PUMP OIL ORV40 500ML | 01/01/1900 | 31/12/2099 | |
| 12 | 1600500 | PUMP OIL ORV40 1L | 01/01/1900 | 31/12/2099 | |
| 12 | 1601037 | PUMP OIL ORV40 10L | 01/01/1900 | 31/12/2099 | |
| 13 | 1601050 | KIT MINOR LB18/LC20- LB25/LA20 (K1000038) (EXHAUST FILTER) | 02/01/1900 | 31/12/2099 | |
| 14 | 1604136 | MAJOR KIT FOR VACUUM PUMP LC20 (K1000039) | 02/01/1900 | 31/12/2099 | |
| 15 | 1604140 | LID PLEXIGLAS C412/420 1B (NO IDROF.) | 01/01/1900 | 08/10/2014 | 1B |
| 15 | 1604141 | LID PLEXIGLAS C412/420 2B (NO IDROF.) | 01/01/1900 | 08/10/2014 | 2B |
| 15 | 1602422 | LID PLEXIGLAS C412/420 1B IDROF. | 09/10/2014 | 31/12/2099 | 1B IDROF. |
| 15 | 1602421 | LID PLEXIGLAS C412/420 2B IDROF. | 09/10/2014 | 31/12/2099 | 2B IDROF. |
| 16 | 1604018 | BLACK COVER SEAL 2 MT | 01/01/1900 | 31/12/2099 | |
| 17 | 1604145 | GAS PRESSURE SPRINGS (1 PC) 198.155.48 (NO IDROF.) | 01/01/1900 | 08/10/2014 | |
| 17 | 1602428 | GAS PRESSURE SPRINGS (1 PC) 198.155.52 (IDROF.) | 09/10/2014 | 31/12/2099 | IDROF. |
| 18 | 1604149 | SOLENOID VALVE UNIT C312/412/420 230V | 01/01/1900 | 31/12/2099 | 230V |
| 18 | 1604161 | SOLENOID VALVE UNIT C312/412/420 110V | 01/01/1900 | 31/12/2099 | 110V |
| 18 | 1604157 | SOLENOID VALVE KIT C312/412/420 100V | 01/01/1900 | 31/12/2099 | 100V |
| 19 | 1603294 | POWER CABLE 3X14AWG AI111USA -UL- | 01/01/1900 | 31/12/2099 | 110V |
| 19 | 1604162 | POWER CABLE 3X2X2000-KP-2188 JAP | 01/01/1900 | 31/12/2099 | 100V |
| 19 | 1603293 | POWER CABLE 3X1,5X3000 SHUKO EUR | 01/01/1900 | 31/12/2099 | 230V |
| 20 | 1603335 | SILICONE RUBBER 29X8X415 | 01/01/1900 | 31/12/2099 | |
| 21 | 1603449 | SWITCH CONTACT MC | 01/01/1900 | 01/12/2014 | SWITCH |
| 21 | 1603692 | REED CONTACT MC-N | 01/01/1900 | 31/12/2099 | REED |
| 22 | 1604059 | SOLENOID VALVE 1/8" FF D2 NBR 230V | 01/01/1900 | 31/12/2099 | 230V |
| 22 | 1604167 | GASFLUSH SOLENOID VALVE 1/8" FF Ø2 NBR 110V 50/60HZ (5510) | 01/01/1900 | 31/12/2099 | 110V |
| 22 | 1604167 | GASFLUSH SOLENOID VALVE 1/8" FF Ø2 NBR 110V 50/60HZ (5510) | 01/01/1900 | 31/12/2099 | 100V |
| 23 | 1604071 | MAIN SWITCH 20A | 01/01/1900 | 31/12/2099 | |
| 24 | 1602045 | THERMIC CIRCUIT BREAKER C308/310/312/EVOX25/SPACE25 | 17/12/2015 | 31/12/2099 | |
| 25 | 1604861 | D8X6 BLUE HOSE (1 MT) ELLASTOLAN | 01/01/1900 | 31/12/2099 | |
| 26 | 1604591 | WHITE SIL. TUBE D2X6 FOR SENSOR (1 MT) | 01/01/1900 | 31/12/2099 | |
| 27 | 1604375 | ARMORVIN HOSE D=16 (1 MT) | 01/01/1900 | 31/12/2099 | |
| 28 | 1601611 | OIL SIGHT (1105004) | 01/01/1900 | 31/12/2099 | |
| 29 | 1605096 | TANK GASKET PUMP LC20 (4901071) | 01/01/1900 | 31/12/2099 | |
| 30 | 1604489 | PUMP OIL REFILL SCREW 1/2" (2 PCS.) | 01/01/1900 | 31/12/2099 | |
| 31 | 1605054 | LID HINGE SUPPORT LERICA C-SERIES | 01/01/1900 | 31/12/2099 | |
| 32 | 1604606 | SAFETY RUBBER NUBS (5 PCS) C420/EVOX30/EVOX31 HI-LINE | 01/01/1900 | 31/12/2099 | |