

MOD: XF193

EXPLODED VIEW DISEGNO ESPLOSO

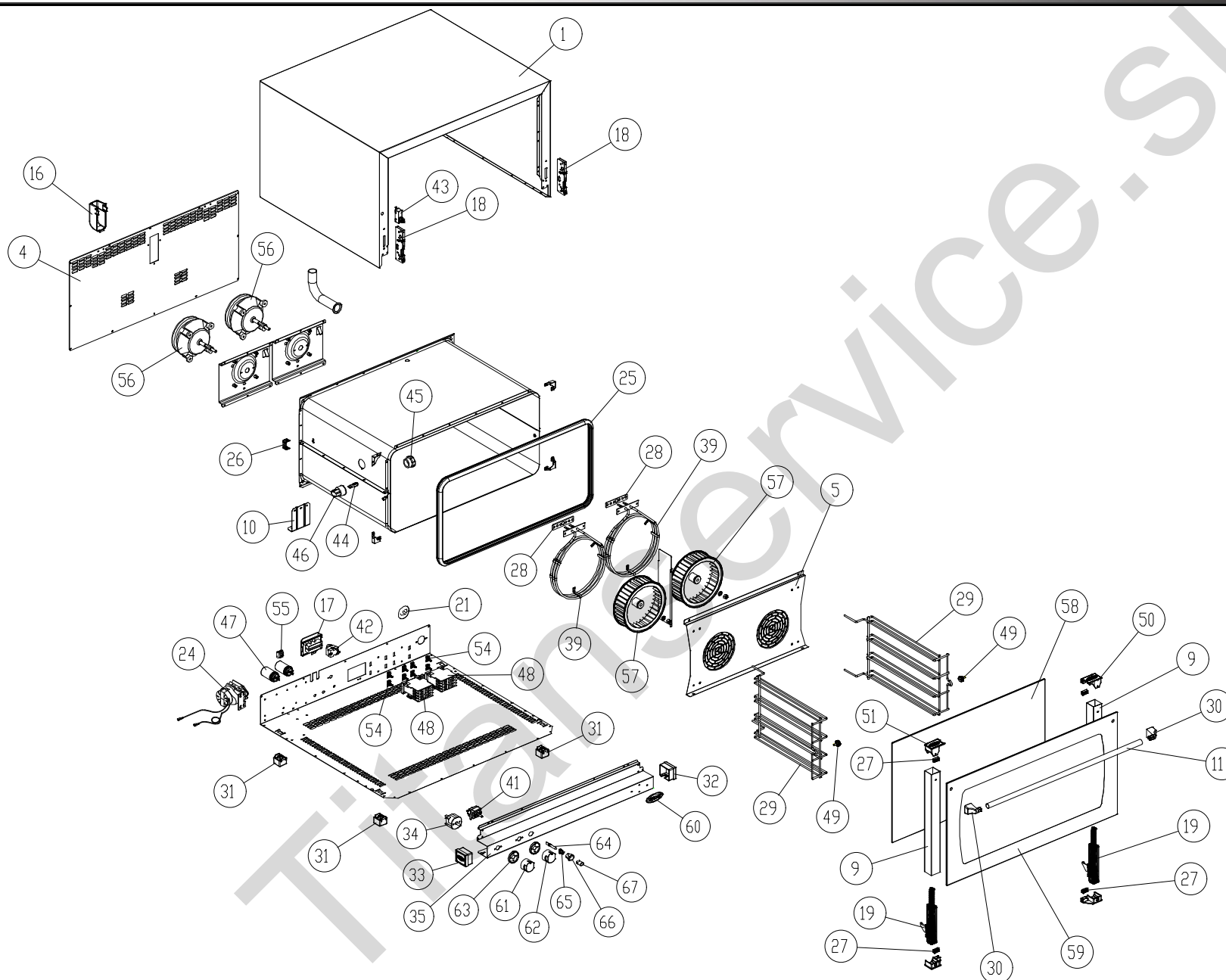

LEGEND - LEGENDA

| | | | |
|----|-----------|----|----------|
| 1 | OD1285A1 | 56 | VN1000B0 |
| 4 | OF1095A1 | 57 | VN1025A0 |
| 5 | OG1125B1 | 58 | VT1070A0 |
| 9 | OH1425A0 | 59 | VT1071A2 |
| 10 | OH1455A0 | 60 | ED1070A0 |
| 11 | OH1930A0 | 61 | MN1090A0 |
| 15 | OH2015A0 | 62 | MN1091A0 |
| 16 | VM1065A0 | 63 | MN1095A0 |
| 17 | CE1130A0 | 64 | VE177 |
| 18 | CR1000A0 | 65 | VE162 |
| 19 | CR1025A0 | 66 | VE1170A0 |
| 21 | VM1130A0 | 67 | VE164 |
| 24 | VN032 | | |
| 25 | GN1110A2 | | |
| 26 | OH318A | | |
| 27 | GN1130A0 | | |
| 29 | GRL1025A0 | | |
| 30 | MG1015A0 | | |
| 31 | PD1000A0 | | |
| 32 | VM1115A0 | | |
| 33 | VM1116A0 | | |
| 34 | TM023 | | |
| 35 | OD1425A0 | | |
| 39 | RS1090A1 | | |
| 41 | TR006 | | |
| 42 | TR255B | | |
| 43 | VE086B | | |
| 44 | VE1005A1 | | |
| 45 | VE036 | | |
| 46 | VE1015A0 | | |
| 48 | VE1095A0 | | |
| 49 | VII035A1 | | |
| 50 | VM1045A0 | | |
| 51 | VM1046A0 | | |
| 54 | VM1075A0 | | |
| 55 | VM250 | | |

MOD: XF193

EXPLODED VIEW DISEGNO ESPLOSO



DESCRIZIONE CODICI

| | | |
|----|-----------|--|
| 1 | OD1285A1 | MANTELLINO INOX L.M. ROSSELLA |
| 4 | OF1095A1 | SCHIENA ZINCATA L.M. ROSSELLA |
| 5 | OG1125B1 | CARTER ARIA INOX L.M. ROSSELLA |
| 9 | OH1425A0 | COLONNINA SX/DX PORTA L.M. ARIANNA-ROSSELLA |
| 10 | OH1455A0 | STAFFA SOSTEGNO MUFFOLA L.M. |
| 11 | OH1930A0 | TUBO MANIGLIA D-est=18 Sp=1 L=718 INOX L.M. 800 |
| 15 | OH2015A0 | PROFILO SOSTEGNO MOTORE XV203G/403G L.M. |
| 16 | VM1065A0 | CUFFIA COPRI CAMINO FUMI L.M. |
| 17 | CE1130A0 | CAVO 5x1,5mmq H07RN-F L=1,5m + MORS. K1/6 |
| 18 | CR1000A0 | ATTACCO CERNIERA PORTA FORNO RIBALTA L.M. |
| 19 | CR1025A0 | CERNIERA PORTA FORNO RIBALTA L.M. ROSSELLA |
| 21 | VM1130A0 | TAPPO PVC NERO DEST=38.2 DINT=31.5 PER LAM. SP=1.6 |
| 24 | VN032 | INVERTITORE P19.5J.02.H6.17 -0198 |
| 25 | GN1110A2 | GUARNIZIONE PORTA PROFILO 248 LINEMISS-XCH030 |
| 26 | OH318A | SOSTEGNO BULBO STANDARD '02 |
| 27 | GN1130A0 | GUARNIZIONE SUPPORTO VETRO L.M. L=23mm |
| 29 | GRL1025A0 | GRIGLIA LATERALE DX/SX CROMATA 4TG 600x400 L.M. ROSSELLA |
| 30 | MG1015A0 | TERMINALE MANIGLIA L.M. |
| 31 | PD1000A0 | PIEDINO QUADRO 35X35 H26 NYLON CARICATO VETRO GRIGIO |
| 32 | VM1115A0 | TAPPO DX CRUSCOTTO COMANDI IN PLASTICA L.M. MANUAL |
| 33 | VM1116A0 | TAPPO SX CRUSCOTTO COMANDI IN PLASTICA L.M. MANUAL |
| 34 | TM023 | TIMER MI2 120 min 2678 A 250V 16A |
| 35 | OD1425A0 | CRUSCOTTO COMANDI MANUALE INOX L.M. 800 |
| 39 | RS1090A1 | RESISTENZA CIRCOLARE D=230 3 SPIRE H78 2900W 230V |
| 41 | TR006 | TERMOSTATO 50-295°C 55.19052.861 |
| 42 | TR255B | TERMOSTATO SIC.+UNIPOL. 330°C Ty95H L=1300mm |
| 43 | VE086B | MICROINTERRUTTORE PORTA MF09 16A |
| 44 | VE1005A1 | LAMPADA ALOGENA 40W 230V |
| 45 | VE036 | VETRO PORTALAMPADA 77.222.-019.00 |
| 46 | VE1015A0 | PORTA LAMPADA PER LAMPADA ALOGENA |
| 48 | VE1095A0 | TELERUTTORE GE 25A 230V 50/60 Hz CL01A400T6 |
| 49 | V11035A1 | NOTTOLINO M6x12,5 CON TAGLIO OTT.CROM.FERMA GRIGIE X |
| 50 | VM1045A0 | TAPPO SUP. DX COLONNINA PORTA VETRO INTERNO LINEMISS |
| 51 | VM1046A0 | TAPPO SUP. SX COLONNINA PORTA VETRO INTERNO LINEMISS |
| 54 | VM1075A0 | CLIP DI RISSAGGIO PER TELERUTTORI |
| 55 | VM250 | MORSETT. A PETTINE |

| | | |
|----|----------|--|
| 56 | VN1000B0 | MOTORE COND.5uF 200W ALB.M8 CONN.5 POLI |
| 57 | VN1025A0 | VENTOLA D=196 H=61 38 PALE DADO M8 |
| 58 | VT1070A0 | VETRO INTERNO 715X414X4 BETFL L.M. ROSSELLA |
| 59 | VT1071A2 | VETRO ESTERNO SER. GIALLO 798X424X5 TFL L.M. ROSSELLA |
| 60 | ED1070A0 | ETICHETTA UNOX ELUSSE 78x33 ARGENTO CON BORDO EST. |
| 61 | MN1090A0 | MANOPOLA SERIGR. TIMER 0-120 MIN NICHELATA SATINATA L.M. |
| 62 | MN1091A0 | MANOPOLA SERIGR. TERMOMETRO 80-300°C NICHELATA SATI |
| 63 | MN1095A0 | GHIERA CON INDICE STAMPATO NICHELATA SATINATA L.M. MA |
| 64 | VE177 | LUCE SPIA FLUORO STD 230V |
| 65 | VE162 | SUPPORTO LAMPADA INTERNO |
| 66 | VE1170A0 | SUPPORTO D16 ELLITTICO NICHEL OPACO |
| 67 | VE164 | GEMMA VERDE TERMOMETRO ORO |

DESCRIPTION

| | | |
|----|-----------|---|
| 1 | OD1285A1 | |
| 4 | OF1095A1 | ZINCED BACK PANEL L.M. ROSSELLA |
| 5 | OG1125B1 | |
| 9 | OH1425A0 | |
| 10 | OH1455A0 | |
| 11 | OH1930A0 | STAINLESS STEEL HANDLE TUBE D-est=18 Sp=1 L=718 L.M. ELENA- |
| 15 | OH2015A0 | |
| 16 | VM1065A0 | |
| 17 | CE1130A0 | CABLE 5x1,5mmq H07RN-F L=1,5m + TERMINAL BOX K1/6 |
| 18 | CR1000A0 | HINGE LATCH L.M. |
| 19 | CR1025A0 | |
| 21 | VM1130A0 | |
| 24 | VN032 | REVERS SWITCH MOTOR P19.5J.02.H6.17 |
| 25 | GN1110A2 | |
| 26 | OH318A | |
| 27 | GN1130A0 | INT. GLASS SEAL L.M. L=22mm |
| 29 | GRL1025A0 | RIGHT/LEFT LAT.GRID CHROMIUM-PLATED 4 TRAYS 600x400 L.M |
| 30 | MG1015A0 | HANDLE END L.M. |
| 31 | PD1000A0 | GREY SQUARE FOOT 35x35 H26 NYLON WITH GLASS |
| 32 | VM1115A0 | |
| 33 | VM1116A0 | |
| 34 | TM023 | TIMER MI2 120 min 2678 A 250V 16A |
| 35 | OD1425A0 | |
| 39 | RS1090A1 | |
| 41 | TR006 | |
| 42 | TR255B | SAFETY THERMOSTAT+UNIPOL. 330°C Ty95H L=1300mm |
| 43 | VE086B | DOOR MICROSWITCH MF09 16A |
| 44 | VE1005A1 | HALOGEN LAMP 40W |
| 45 | VE036 | IN-LIGHT GLASS COVER 77.222.-019.00 |
| 46 | VE1015A0 | LAMP HOLDER FOR HALOGEN LAMP |
| 48 | VE1095A0 | REMOTE CONTROL SWITCH GE 25A 230V 50/60 Hz CL01A400T6 |
| 49 | V11035A1 | CHROMIUM PLATED BRASS NUT M6x12,5 TO STOP LATERAL SUP |
| 50 | VM1045A0 | RIGHT UPPER LID FOR COLUMN FOR INTERNAL GLASS LINEMISS |
| 51 | VM1046A0 | LEFT UPPER LID FOR COLUMN FOR INTERNAL GLASS LINEMISS |
| 54 | VM1075A0 | CLIP TO FIX CONTACTORS |
| 55 | VM250 | "COMB" TERMINAL BOARD BM 5251 1 B3- |

| | | |
|----|----------|--|
| 56 | VN1000B0 | MOTOR COND.5uF 200W ALB.M8 CONN.5 TERMINALS |
| 57 | VN1025A0 | FAN D=196 h=61 38 BLADES NUT M8 |
| 58 | VT1070A0 | INTERNAL GLASS 715x414x4 BETFL L.M. ROSSELLA |
| 59 | VT1071A2 | |
| 60 | ED1070A0 | UNOX ELLIPTICAL STICKER 78x33-SILVER WITH EXTERNAL FRAME |
| 61 | MN1090A0 | |
| 62 | MN1091A0 | |
| 63 | MN1095A0 | |
| 64 | VE177 | FLUORINE WARNING LIGHT STD 230V |
| 65 | VE162 | INTERNAL PILOT LAMP SUPPORT |
| 66 | VE1170A0 | |
| 67 | VE164 | GREEN PILOT WITH GOLD THERMOMETER SERIGRAPHY |