

### LEGEND - LEGENDA

|    |          |
|----|----------|
| 1  | OH2030A0 |
| 2  | OH2031A0 |
| 3  | OH3745A0 |
| 4  | CE116    |
| 5  | CE1305A0 |
| 6  | CR045    |
| 7  | CR046    |
| 8  | EL1090A0 |
| 9  | EL1125A0 |
| 10 | EL1195A0 |
| 11 | GN006A   |
| 12 | GN1120A0 |
| 13 | GN1200A0 |
| 14 | GN1245A1 |
| 15 | MG1035A1 |
| 16 | PD1015A0 |
| 17 | PE1640A0 |
| 18 | PE1415B1 |
| 19 | RC1030A1 |
| 20 | RC1210A0 |
| 21 | RC492B   |
| 22 | RS1095A0 |
| 23 | TB008    |
| 25 | TR1015A0 |
| 26 | TR1050A0 |
| 27 | VE1120B0 |
| 28 | VE1130A0 |
| 30 | VM1280A0 |
| 31 | VM250    |
| 32 | VT1165A0 |

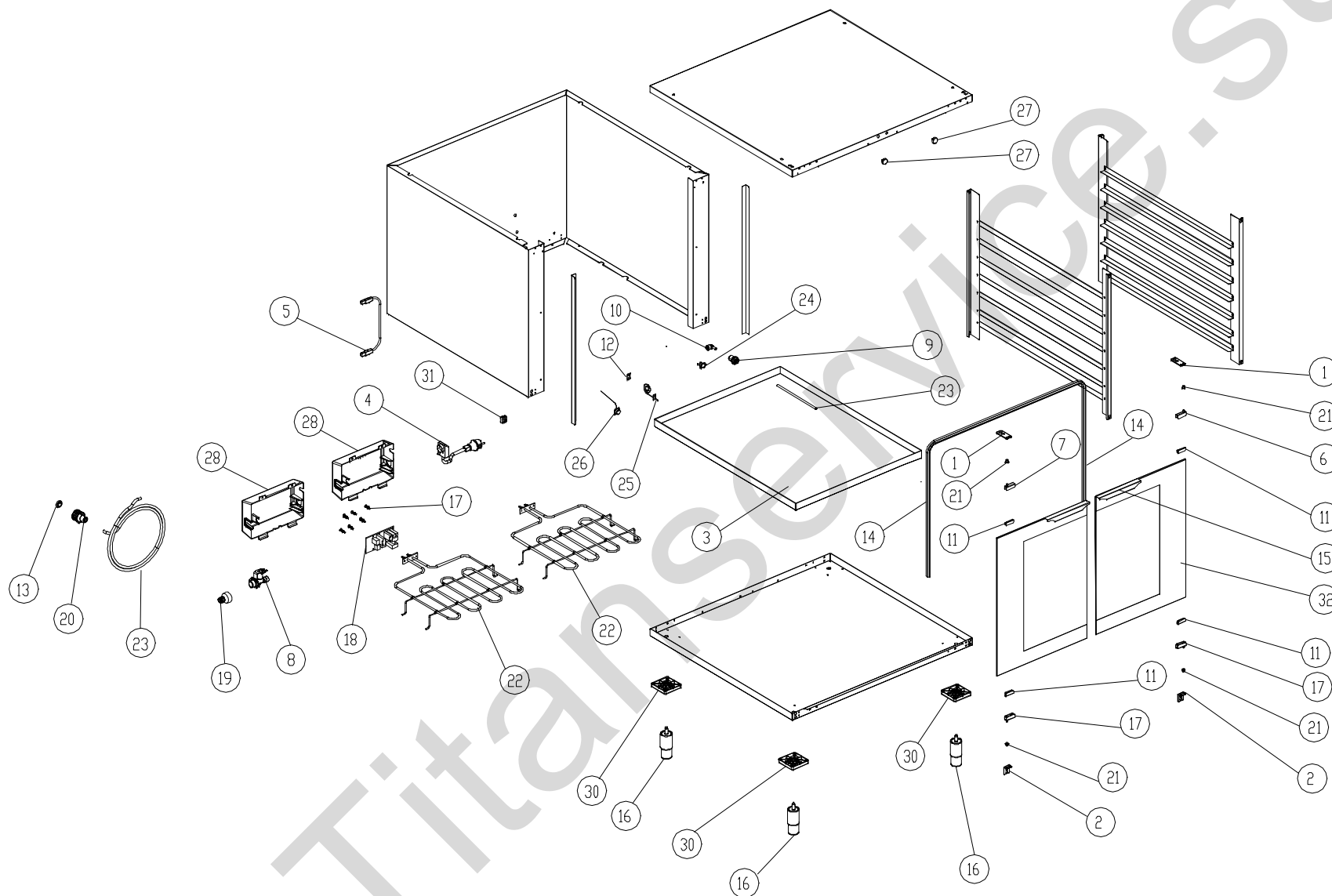

# MOD: XL404

## EXPLODED VIEW DISEGNO ESPLOSO



### DESCRIZIONE CODICI

|    |          |   |
|----|----------|---|
| 1  | 0H2030A0 | STAFFA INOX SUPERIORE PORTA SERIE XL                    |
| 2  | 0H2031A0 | STAFFA INOX INFERIORE PORTA SERIE XL                    |
| 3  | 0H3745A0 | VASCA UMIDITA' INOX XL404                               |
| 4  | CE116    | CAVO 3x1,5 H07RN-F MT1,5+K1/3+SCHUKO                    |
| 5  | CE1305A0 | CAVO RJ45 - RJ45 L=2MT                                  |
| 6  | CR045    | CERN.DX INOX XV-XL-XB                                   |
| 7  | CR046    | CERN.SX INOX XV-XL-XB                                   |
| 8  | EL1090A0 | ELETT. SINGOLA ATT. J.GUEST INCORPORATO CON RID.VERDE.T |
| 9  | EL1125A0 | PASSAPARETE Ø8  |
| 10 | EL1195A0 | RACCORDO A GOMITO CON J.GUEST CODOLO D8 - D8            |
| 11 | GN006A   | GUARN.PORTA FREDDA A BAND. PTFE CAR/CARB Sp=1mm         |
| 12 | GN1120A0 | GUARNIZIONE Sonda DI TEMPERATURA NTC                    |
| 13 | GN1200A0 | GUARNIZIONE D=24 RACCORDO 3/4 GOMMA+RETE                |
| 14 | GN1245A1 | GUARNIZIONE PORTA NERA 8G XL404                         |
| 15 | MG1035A1 | MANIGLIA INOX SERIE XL                                  |
| 16 | PD1015A0 | PIEDINO REGOLABILE D=45 H=70-100 INOX                   |
| 17 | PE1640A0 | DISTANZIALE NYLON 5,8MM FASTPOINT                       |
| 18 | PE1415B1 | SCHEDA POTENZA MANTENITORE SERIE I                      |
| 19 | RC1030A1 | RACCORDO DIRITTO D=8 - 3/4                              |
| 20 | RC1210A0 | RACCORDO 3/4 FEMM. - J.GUEST Ø8 CON FILTRO E VNR        |
| 21 | RC492B   | BOCCOLA PER CR045-46 12X6,5 DI=5,3 AISI304              |
| 22 | RS1095A0 | RESISTENZA PIANA 1200 W 230 V                           |
| 23 | TB008    | TUBO PE 7,93x4,75 TRASPARENTE                           |
| 25 | TR1015A0 | SONDA DI TEMP. NTC UL                                   |
| 26 | TR1050A0 | SONDA UMIDITA'  |
| 27 | VE1120B0 | MAGNETE NEODIMIO D22 10N FILETTATURA M6                 |
| 28 | VE1130A0 | SCATOLA PORTA COMPONENTI LIEVITATORI                    |
| 30 | VM1280A0 | STAFFA PER RUOTA NYLON GRIGIO                           |
| 31 | VM250    | MORSETT. A PETTINE                                      |
| 32 | VT1165A0 | VETRO ESTERNO SER. 429X582X5 CHIARO TFL XL404           |

### DESCRIPTION

|    |          |   |
|----|----------|---|
| 1  | 0H2030A0 | STAINLESS STEEL UPPER BRACKET FOR DOOR SERIE XL       |
| 2  | 0H2031A0 | STAINLESS STEEL LOWER BRACKET FOR DOOR SERIE XL       |
| 3  | 0H3745A0 |   |
| 4  | CE116    | EL CABLE 3x1.5 H07RN-F MT1.5+K1/3+SCHUKO              |
| 5  | CE1305A0 | RJ45 - RJ45 CABLE L=2MT                               |
| 6  | CR045    | RIGHT STAINLESS STEEL HINGE XV-XL-XB                  |
| 7  | CR046    | LEFT STAINLESS STEEL HINGE XV-XL-XB                   |
| 8  | EL1090A0 | WATER SINGLE ELECTROV.W/RAPID CONNECTION J.GUEST AND  |
| 9  | EL1125A0 | WALL PASSING SEAL Ø8                                  |
| 10 | EL1195A0 | ELBOW UNION WITH J.GUEST TERMINAL D8 - D8             |
| 11 | GN006A   | COLD DOOR SEAL PTFE CAR/CARB Thickness=1mm            |
| 12 | GN1120A0 | TEMPERATURE PROBE NTC SEAL                            |
| 13 | GN1200A0 | 3/4 CONNECTION SEAL D=24 RUBBER+NET                   |
| 14 | GN1245A1 |   |
| 15 | MG1035A1 | STAINLESS STEEL HANDLE SERIE XL                       |
| 16 | PD1015A0 | STAINLESS STEEL ADJUSTABLE FOOT D=45 H=70-100         |
| 17 | PE1640A0 | NYLON SPACER 5,8mm                                    |
| 18 | PE1415B1 |   |
| 19 | RC1030A1 | 3/4 STRAIGHT CONNECTION D=8                           |
| 20 | RC1210A0 | Ø8 J.GUEST 3/4 FEMALE CONNECTION WITH FILTER+NONRETUR |
| 21 | RC492B   |   |
| 22 | RS1095A0 | FLAT HEATING ELEMENT 1200 W 230 V                     |
| 23 | TB008    | TRANSPARENT TUBE PE 7,93x4,75                         |
| 25 | TR1015A0 | TEMPERATURE PROBE NTC UL                              |
| 26 | TR1050A0 | HUMIDITY PROBE  |
| 27 | VE1120B0 | NEODYMIUM MAGNET D22 10N THREAD M6                    |
| 28 | VE1130A0 | BOX FOR COMPONENTS FOR PROVERS                        |
| 30 | VM1280A0 | GREY NYLON BRACKET FOR WHEELS                         |
| 31 | VM250    | "COMB" TERMINAL BOARD                                 |
| 32 | VT1165A0 |   |