

EXPLODED VIEW BM20

Table 1

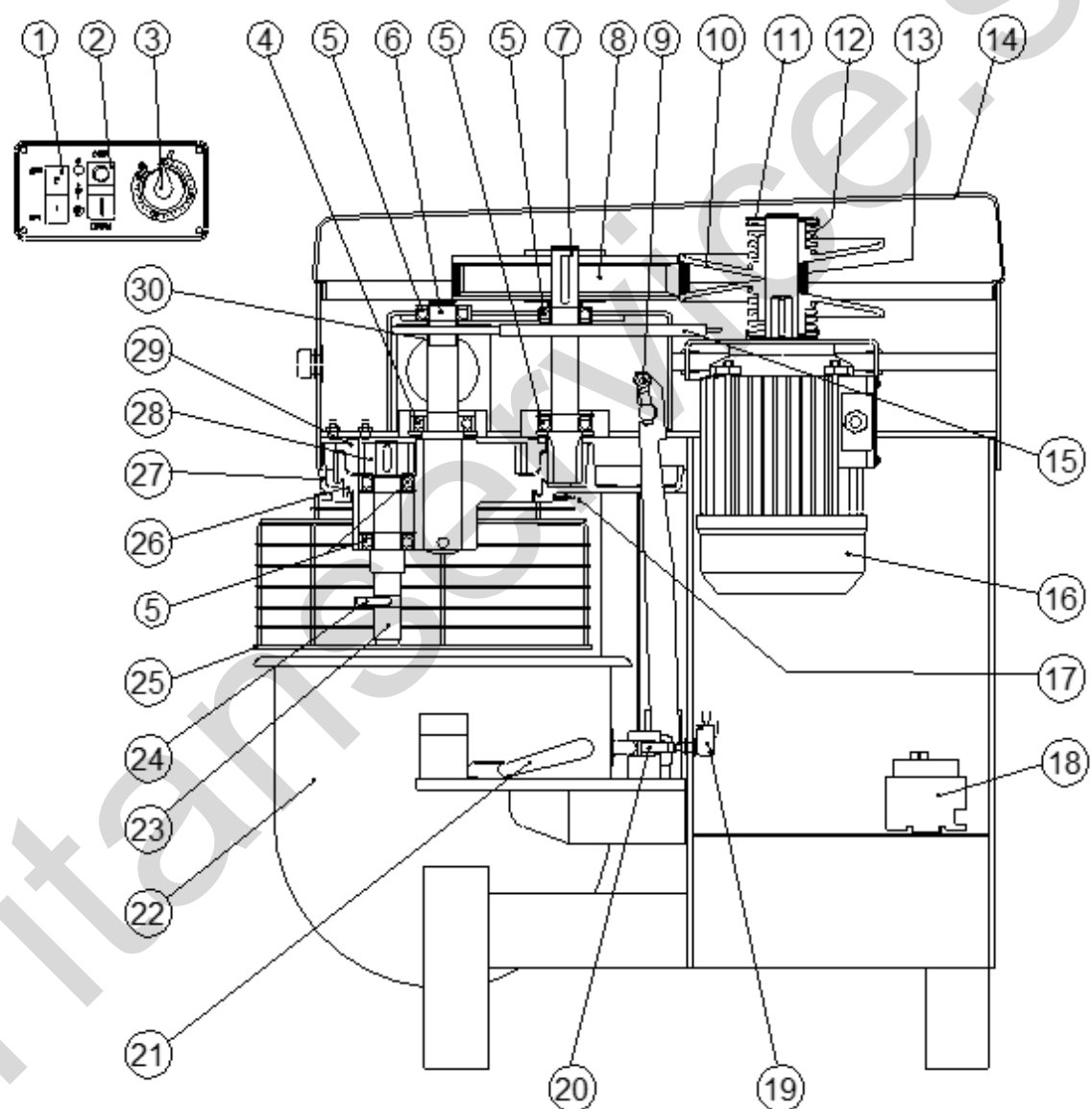

EXPLODED VIEW BM20

Table 2

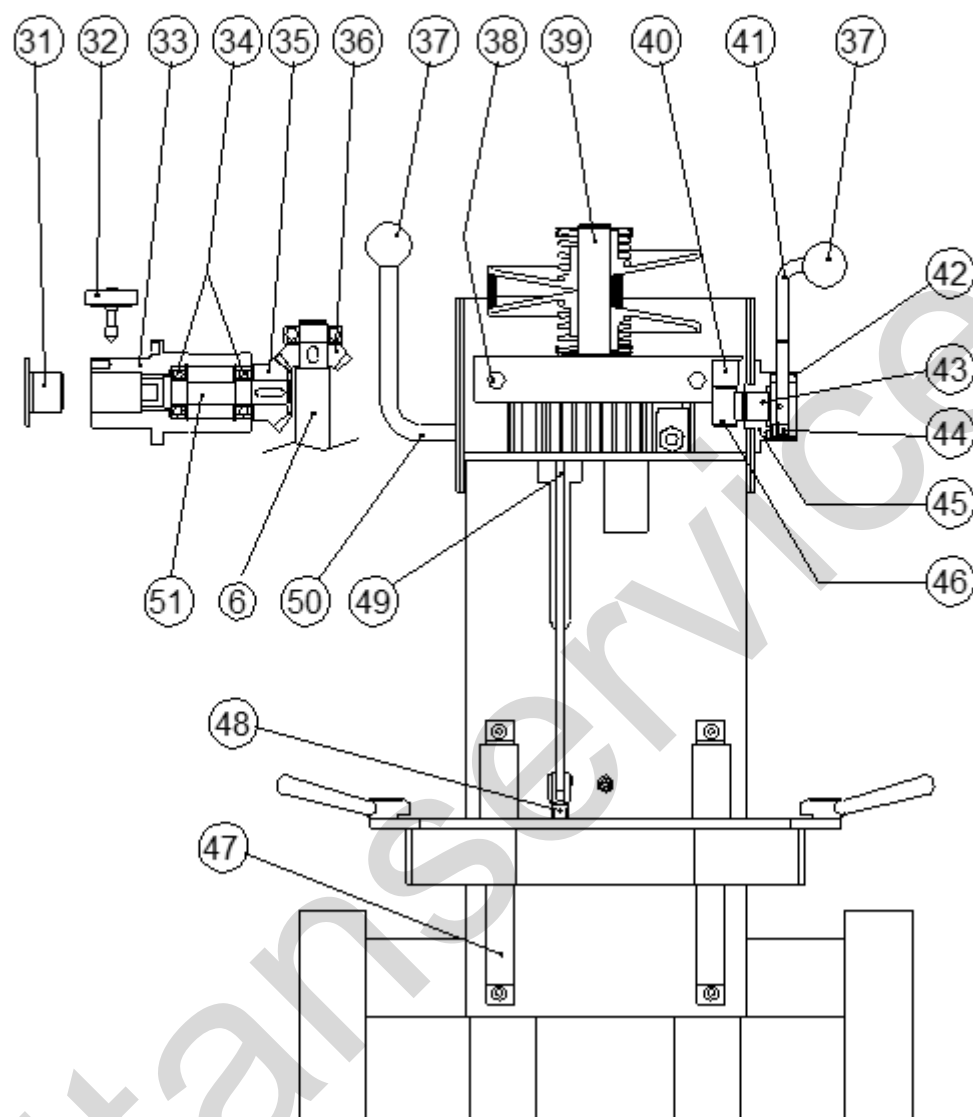

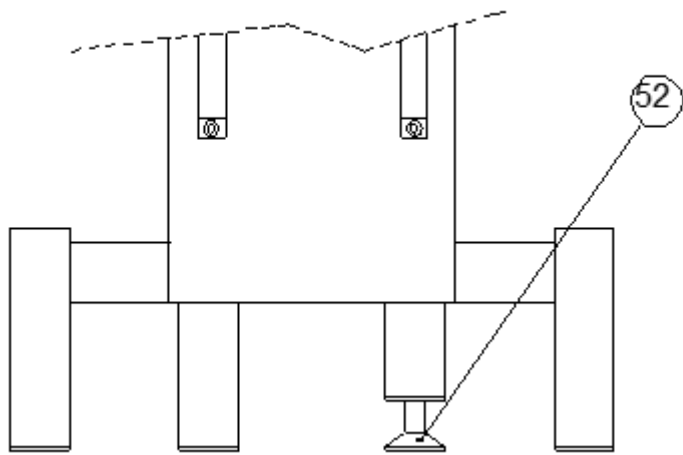

BM20H

Titanservice.su

SPARE PARTS LIST FOR PLANETARY MIXER BM20

| N° RIF. | N° CODE | DESCRIPTION | QUANTITY |
|---------|----------|--|----------|
| 01 | 25003045 | Three phase switch + protection 25003047 | 1 |
| | 25003046 | Single phase switch+ protection 25003047 | |
| 02 | 25009058 | Square button QT011 | 1 |
| 03 | 25007038 | Timer + Knob 25007039 | 1 |
| 04 | 13000017 | Ball bearing 6206 2RS 30-62-16 | 1 |
| 05 | 13000016 | Ball bearing 6205 2RS 25-52-15 | 5 |
| 06 | 01097011 | Planetary shaft | 1 |
| 07 | 01097007 | Return shaft | 1 |
| 08 | 01097006 | Drive pulley | 1 |
| 09 | 23010111 | Eye tie rod M8x40 | 2 |
| 10 | 01097004 | Variator half pulley | 2 |
| 11 | 01097089 | Entrainment cover | 2 |
| 12 | 08097021 | Variable pulley's spring | 2 |
| 13 | 01097080 | Variator belt 31x8x1000 | 1 |
| 14 | 03097046 | Upper cover | 1 |
| 15 | 08000002 | Shock absorber 08-085-1 | 1 |
| 16 | 11000701 | Three phase 400V 50Hz gr.80 0,95Kw | 1 |
| | 11000601 | Single phase 230V 50Hz gr.80 0,75Kw | 1 |
| 17 | 25001301 | Microswitch +lever 25001302 | 1 |
| 18 | 25005034 | Remote control switch 3TF2010-3AC2 24V | 1 |
| 19 | 25001320 | Microswitch MV15 | 1 |
| 20 | 01097060 | Bowl presence rod | 1 |
| 21 | 01098108 | Blocking bowl handle | 2 |
| 22 | 32034620 | Bowl | 1 |
| 23 | 01097015 | Tool shaft | 1 |
| 24 | 01098095 | Tool shaft pin | 1 |
| 25 | 05097029 | Protection grid | 1 |
| 26 | 01097009 | Planetary | 1 |
| 27 | 01097019 | Gears protection cover | 1 |
| 28 | 01097013 | Planetary pinion | 1 |
| 29 | 01097012 | Internal toothed crown | 1 |
| 30 | 01097161 | Planetary shaft spacer | 1 |
| 31 | 01097148 | Polyethylene cap for reducer | 1 |
| 32 | 01097138 | Scraper pin | 1 |
| 33 | 01097017 | Reducer support | 1 |
| 34 | 13000015 | Ball bearing 6204 2RS 20-47-14 | 2 |
| 35 | 01097047 | Bevel gear pair for reducer | 1 |
| 36 | 01097016 | Bevel gear for reducer | 1 |
| 37 | 14002203 | Knob PB/41 M8 | 2 |
| 38 | 01097118 | Drive bar for motor chair | 2 |
| 39 | 01097120 | Variable pulley shaft | 1 |
| 40 | 01097038 | Rack pole | 1 |
| 41 | 01098038 | Speed selecting lever | 1 |
| 42 | 01098041 | Closure cover | 1 |
| 43 | 01097036 | Speed pin | 1 |
| 44 | 08098055 | Handle spring | 1 |
| 45 | 01097057 | Speed lever support | 1 |

SPARE PARTS LIST FOR PLANETARY MIXER BM20

| N° RIF. | N° CODE | DESCRIPTION | QUANTITY |
|---------|----------|-------------------------------------|----------|
| 46 | 01097037 | Toothed sprocket | 1 |
| 47 | 01097024 | Drive bars for bowl | 2 |
| 48 | 23010201 | Fork M8 + 23001301 clip for fork M8 | 1 |
| 49 | 01097023 | Bowl lifting tension rod | 1 |
| 50 | 01097022 | Bowl lifting lever | 1 |
| 51 | 01097018 | Shaft for Hobart attach | 1 |
| 52 | 14002822 | Small foot M16 98/6364 | 1 |

LIST OF RECOMMENDED SPARE PARTS FOR BM20 (2 YEARS OPERATION)

| N° RIF. | N° CODE | DESCRIPTION | QUANTITY |
|---------|----------|--|----------|
| 01 | 25003045 | Three phase switch + protection 25003047 | 1 |
| | 25003046 | Single phase switch +protection 25003047 | |
| 02 | 25009058 | Square button QT011 | 1 |
| 03 | 25007038 | Timer + Knob 25007039 | 1 |
| 04 | 13000317 | Ball bearing 6206 2RS 30-62-16 | 1 |
| 05 | 13000316 | Ball bearing 6205 2RS 25-52-15 | 5 |
| 13 | 01097080 | Variator belt 31x8x1000 | 1 |
| 17 | 25001301 | Microswitch +lever 25001302 | 1 |
| 18 | 25005108 | Remote control switch 3TF2010-3AC2 24V | 1 |
| 24 | 01098095 | Tool shaft pin | 1 |